

NEW!

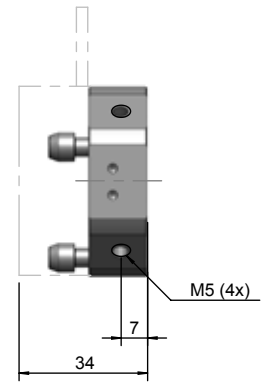
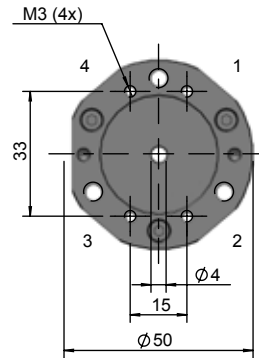

WGS-QLGD Mini

Gripper part, a small quick change system for end of arm tooling. Air tubes will be connected at numbered ports.

Article no	024002
Type	WGS-QLGD Mini
Max pull-, push force	150 N
Max rotating torque	20 Nm
Max bending torque	10 Nm
Air connections	4 x M5
Transmittable media	6 Bar
Vacuum	-1 Bar
Weight	65 g

Accessories



WGS-GPI3



WGS-HQLV Mini



WGS-HQLN Mini